

How to open Bearicuda Stealth 2 Bear cans without the knob.

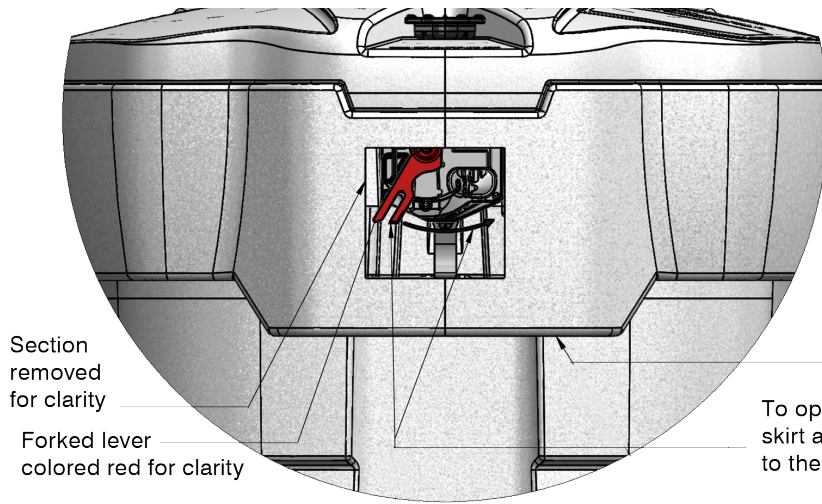

Section removed for clarity

Forked lever colored red for clarity

Skirt for use with refuse collection using semi-automated tipper.

To open the lid without the knob, reach under the skirt and find the forked lever. Move the forked lever to the right until it stops. The lid will now open.

Stealth Wheel Assembly

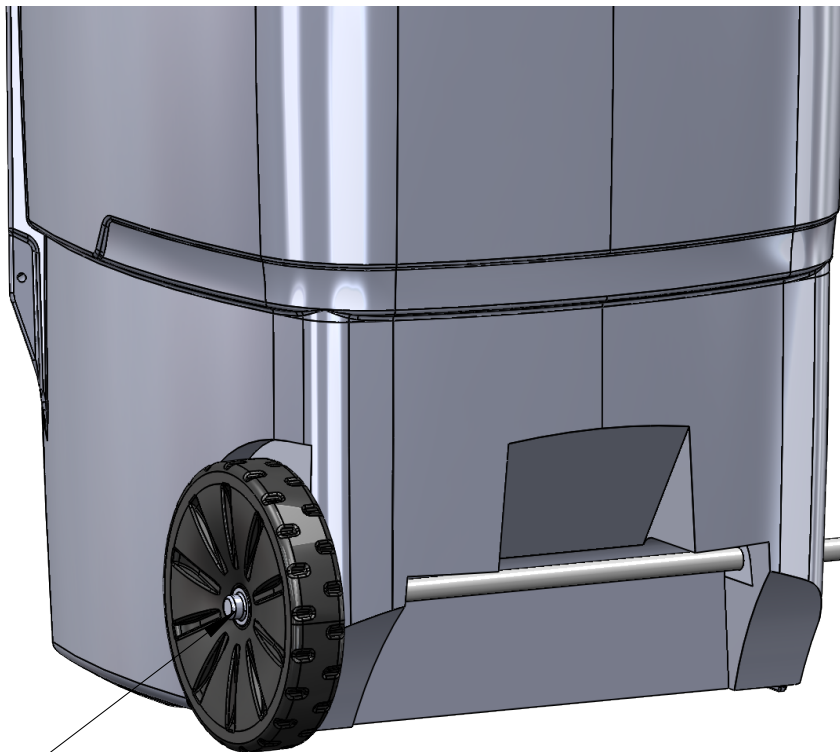

Note:
Most completed containers will not have the axle and wheels installed. They will be sent in the stack of containers to be assembled at their destination.

Five recesses towards the container.

Install one cap onto the axle first then slid one wheel onto the axle so that the correct side of the wheel will face the container when installed. Then insert the axle assembly into the axle holes of the container, slide on the other wheel and install the axle cap.

When installing axle caps use a mallet such as a dead blow or a block of wood between the cap and a hammer to keep from distorting the axle cap.

Installing the rotating knob:

First remove the latch assembly if it's already installed to expose the latch pocket.

Do this by pushing in on the button located on the inside front of the container and pulling up on the latch assembly.

Insert the rotating knob into the hole provided in the front of the container from inside the latch pocket.

Once the knob is in place lightly pull out on the knob and rotate clockwise until it stops. It should be in the position shown.

While holding the knob in this position re-install the latch assembly into the pocket.

The forked lever on the latch assembly should engage with the headed stud on the rotating knob when fully installed.

Rotate the knob counter clockwise to the stop and the hook on the latch assembly will open if installed correctly.

Note:

Before re-installing the latch assembly make sure the button that was pushed in to remove the latch assembly is in place otherwise the latch assembly may not be retained in the pocket securely.

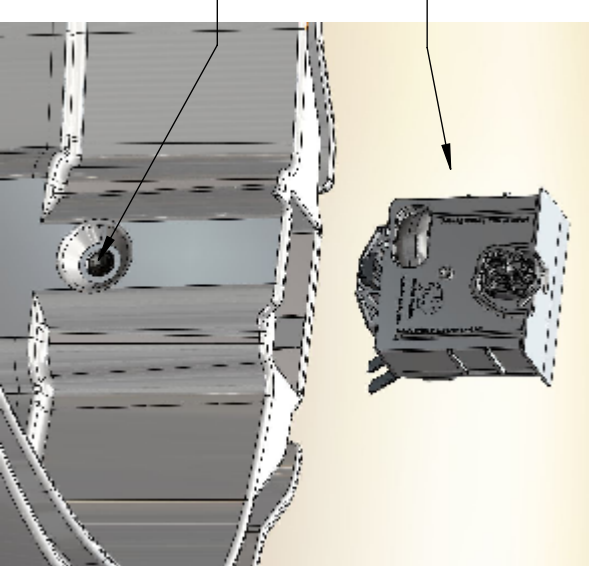

Forked lever will fit over the headed stud when installed correctly.

